

DESIGN OF MEMBERS FOR TENSION

[AISC CH. D]

PROBLEM 1

Calculate the design strength (ϕP_n) of the tension members shown.

*** Check only yield and fracture/rupture. Do not check block shear or bolt limit states.**

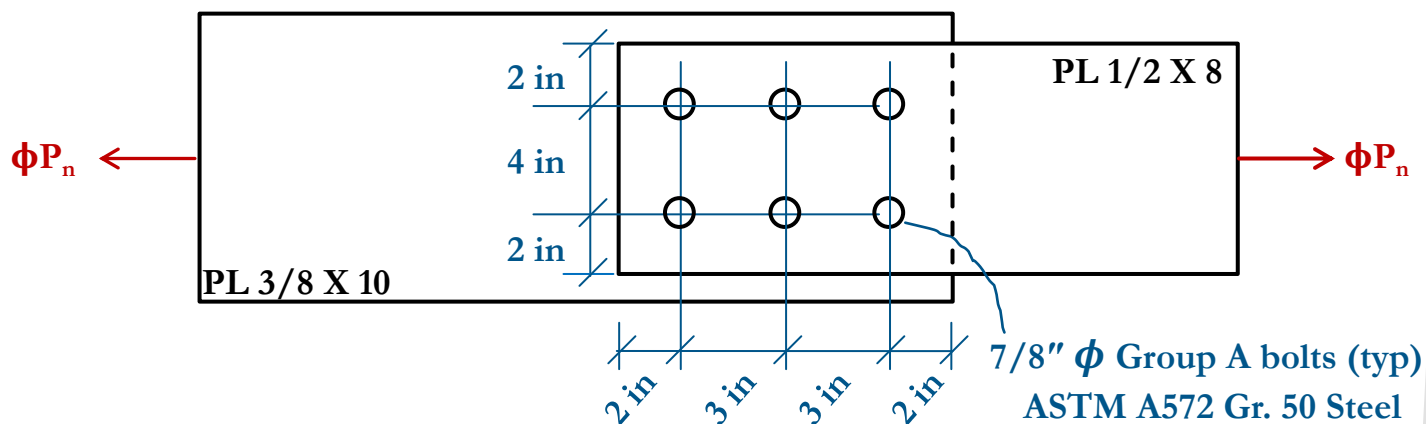

Solution:

Yielding [AISC Ch. D2]

Solution (cont):

Tensile Rupture [AISC Ch. D2, D3]



DESIGN OF MEMBERS FOR TENSION

[AISC CH. D]

PROBLEM 2

Calculate the design strength (ϕP_n) of the tension members shown.

*** Check only yield and fracture/rupture. Do not check block shear or bolt limit states.**

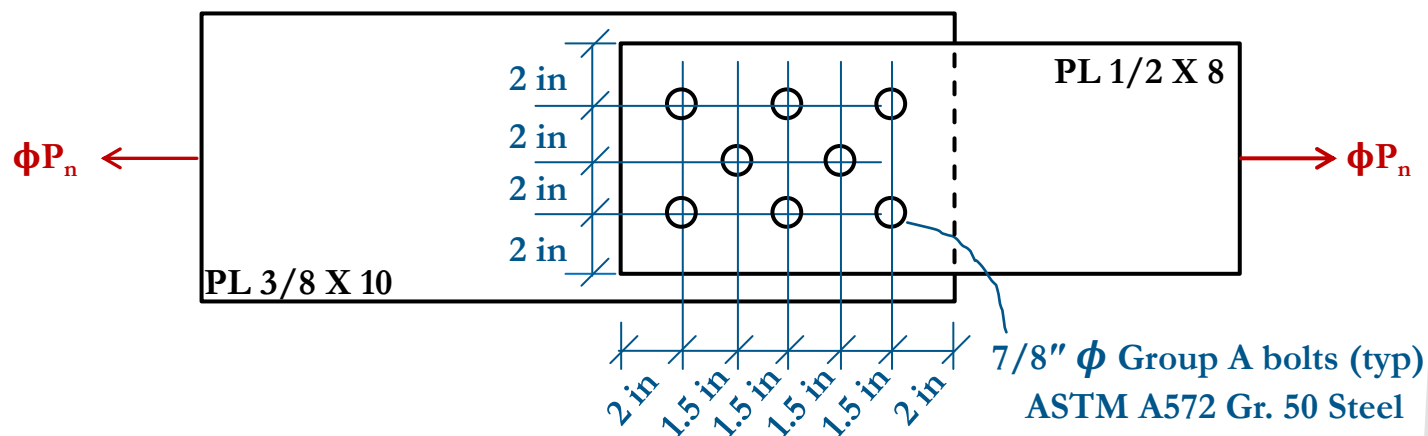

Solution:

Yielding [AISC Ch. D2]



UNIVERSITY
PROGRAMS

aisc.org/teachingaids

Solution (cont):

Tensile Rupture [AISC Ch. D2, D3]

